

## Accessories Miscellaneous Accessories



# RXRX-BS04

Parts List  
01-September-2022

*This parts list is current as of the above revision date.  
See <http://www.rheempartslists.net/92-42800-RXRX-BS04.pdf> for the current revision.*

No.	Notes	Part Description	Part No.
1		Smoke Detector Sampling Tube Assembly - Secondary	45-106983-02
2		Duct Smoke Detector Only	42-106161-03
2		Strain Relief for Smoke Detector (2) - Call for Availability	45-17055-10
2		Power Wiring Harness	45-101998-05
2		Wire Harness	45-101998-03
3		Sensor Only - Photoelectric, 4-Wire	42-106161-01
3		Strain Relief for Smoke Detector - Call for Availability	45-17055-10
3		Wire Harness	45-101998-04
4		Smoke Detector Mounting Bracket	AE-106106-05
5		Smoke Detector Mounting Bracket (extension for tall cabinet)	AE-106106-06
6		Smoke Detector Mounting Bracket (mounts to blower housing)	AE-106106-03
		Tube Bracket	AE-106106-07
		Tubing Clamp (2 included in kit)	64-18940-01
		Sheet Metal Screw (20 included in kit)	63-42109-03

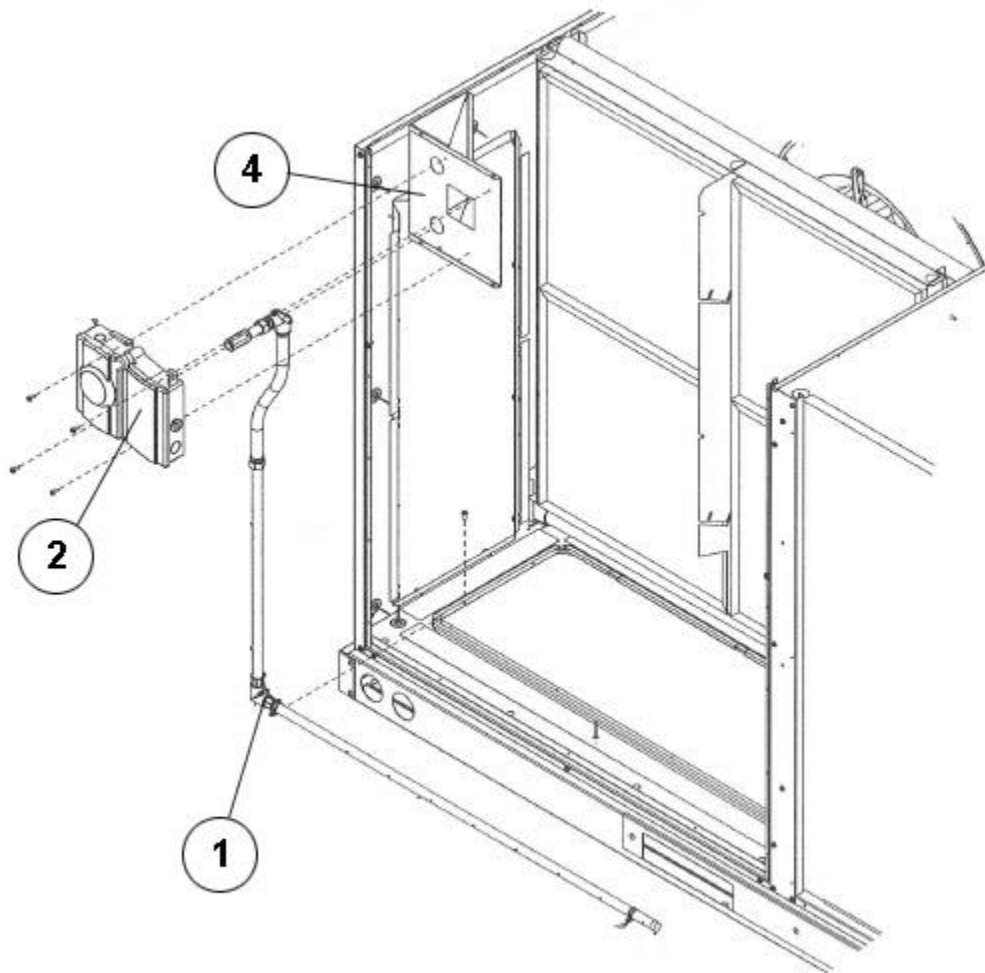

RXRX-BS04 (1) Assembly

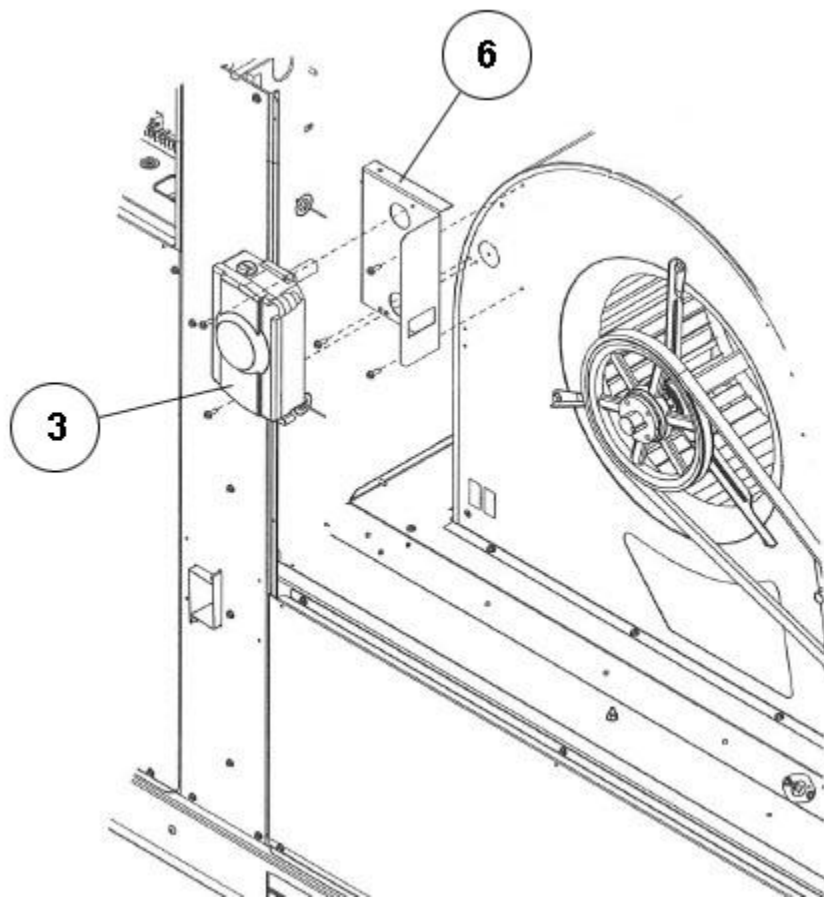

RXRX-BS04 (2) Assembly

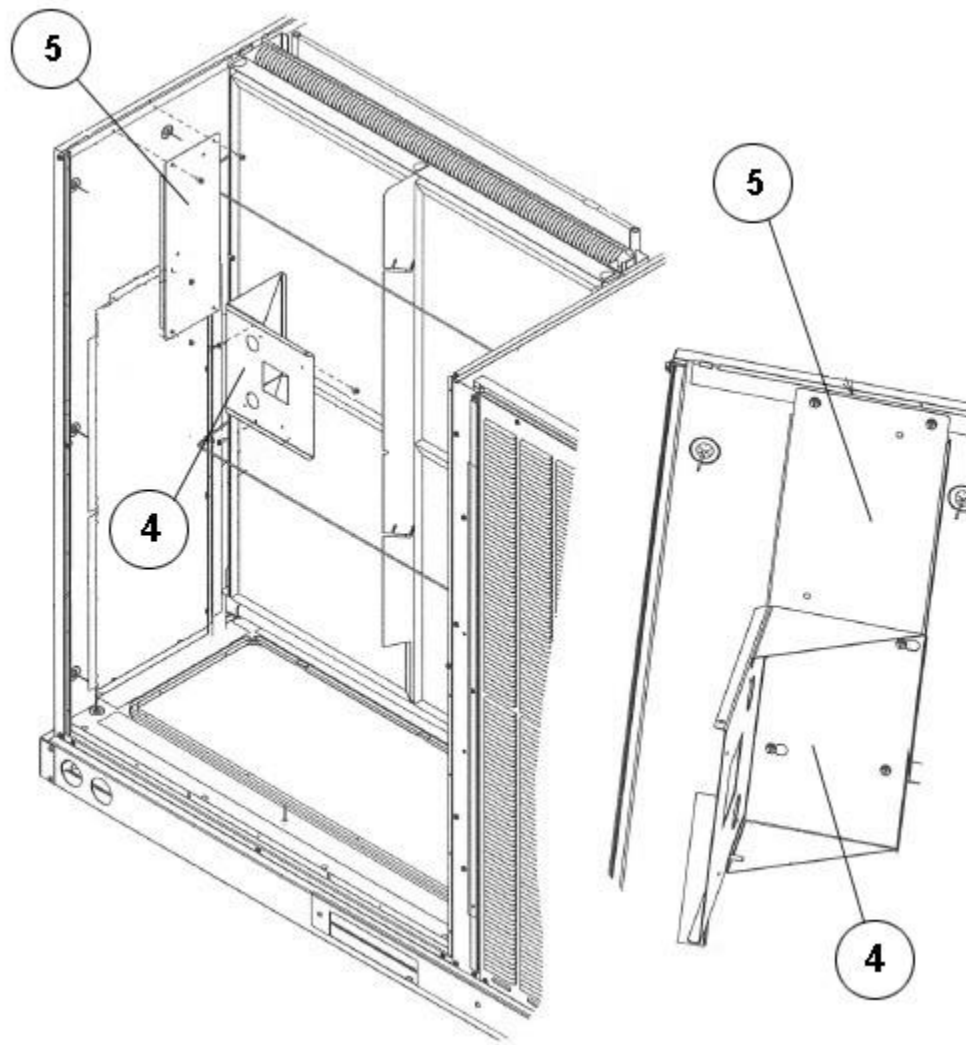

RXRX-BS04 (3) Assembly